

UltraBrakes 2

Read carefully instruction before installation

FEATURES

Material: AL7075T6, Carbon Fibre, Titanium Gr5, Delrin
Compatibility: direct-pull type levers.
Finishing: "hart coat" / black anodized
Graphics: laser etched
Destination: X-Country, Enduro use.

UltraBrakes 2 are designed to be used with UltraLevers 2+ or direct-pull V-brake specific levers.

WARNINGS

- Always insert Brake Pin into **central brake boss hole**.
- **To avoid Linear Spring breakage** and for best performance and feel use low friction cable & housing, tune spring preload at the minimum that allows a proper cable/lever return. Cable housing type and length sensibly influence spring balancing.

INSTALLATION

Brake Arms installation

- 1) Clean and grease brake bosses.
- 2) Insert Linear Spring into Slider.
- 3) Insert Spring Holder and Brake Arm onto brake boss.
- 4) Always insert Brake Pin into central brake boss hole.
- 2) Tighten Mounting Bolt at 4-6Nm (use medium threadlock - Loctite 243).

Pads installation

- 1) Assemble washers exactly as shown in figure. Notice that you can switch position of Thick Spacer (gun metal) and Thin Spacer (black) to get 2 spacing options. Brake pads have to be mounted respecting "forward" direction.

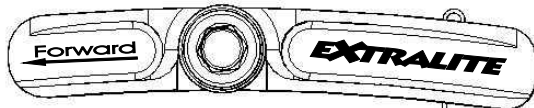

- 2) Check that Brake Arms are parallel when brake pads are on the rim, if not you can switch Spacers.
- 3) Adjust brake pads: manually press both pads against the rim, than tight the Fixing Nut at 6-8Nm (use anti-seize grease on titanium thread). Brake pads have to be parallel to rim and centered on rim braking surface.
WARNING: brake pads should never get in contact with tyre, in any position of brake arms.

Cable installation

- 1) Insert brake cable through the cable pipe and hook it into the Link.
- 2) Insert cable into boot and position it between Anchor Bolt and Groove.
- 3) Pull the cable tight enough to allow 1-1.5mm rim-to-pad clearance.
- 4) Tighten the cable Anchor Bolt to 4-6Nm with a 5mm hex wrench.
- 5) Check that cable operation is smooth before proceeding.

Spring balancing

- 1) Center the brake pads adjusting left/right spring tension. Turn each Micro Adjuster with a 1.5mm hex wrench (clockwise to increase spring tension).
 - 2) Squeeze brake lever and check that Micro Adjusters tuning always allow an even return of left and right Brake Arm.
- NOTICE:** For best performance and feel use low friction cable & housing, tune spring preload at the minimum that allows a proper cable/lever return.
Cable housing type and length sensibly influence spring balancing.

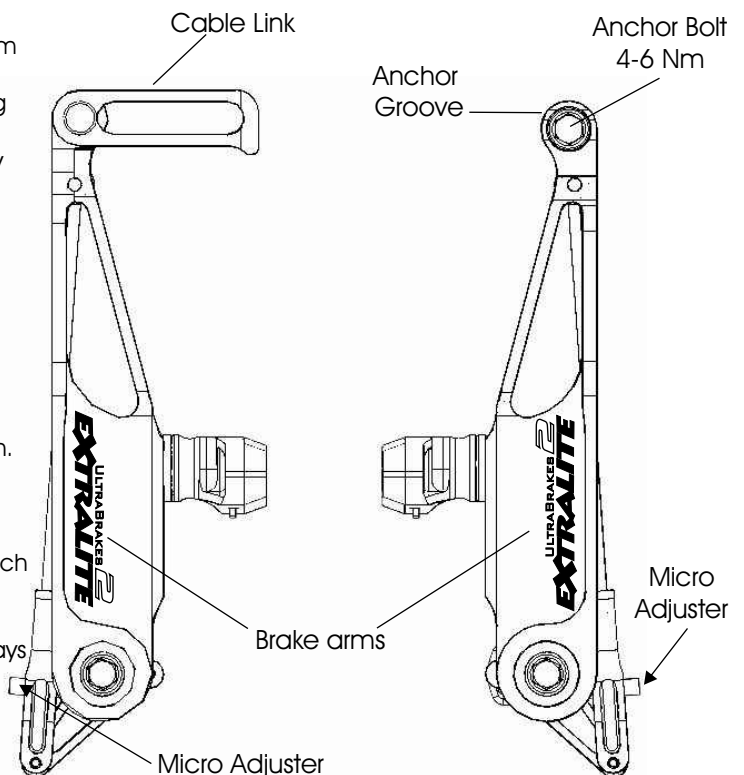
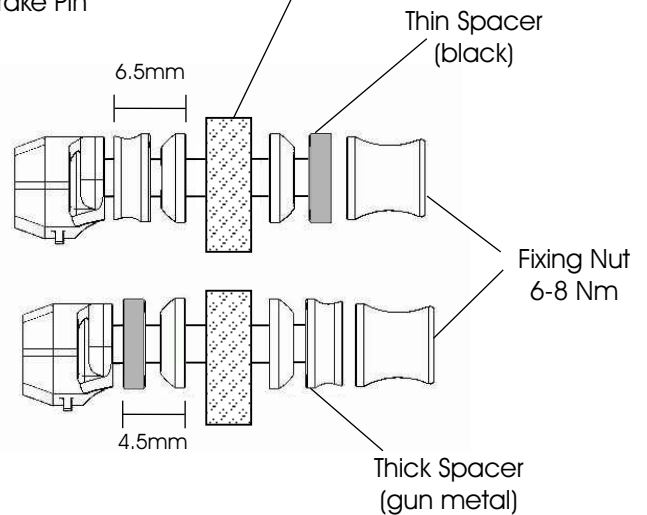
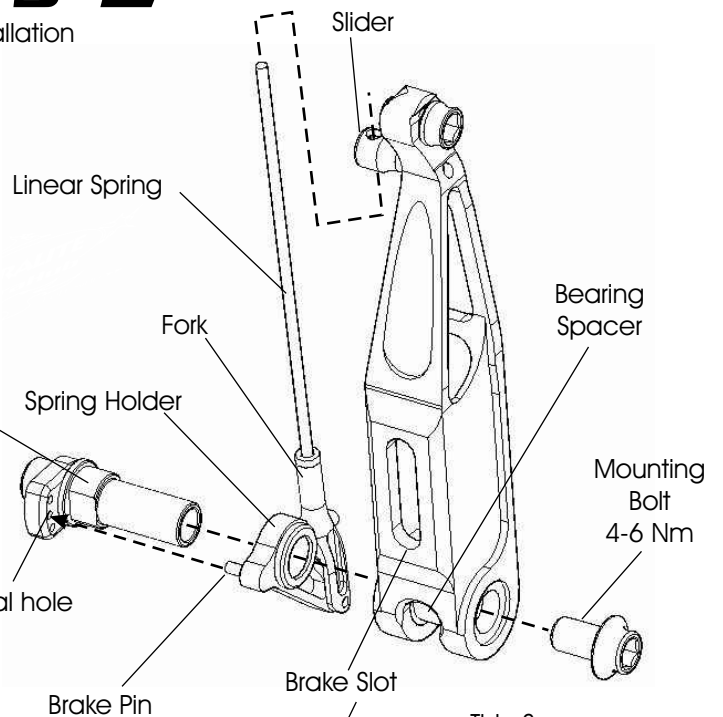

TEST THE SYSTEM

Squeeze brake lever several times to make cable properly seated. Check that cable does not slip at the cable anchor bolt/groove.

Re-torque if necessary.

Test ride in safe conditions. Check again that the complete system is properly mounted and adjusted. Check again brake pad positioning is still correct, adjust and re-torque if necessary.

PAD REPLACING INSTRUCTIONS:

- 1) Remove Keeper Pin from pad holder.
- 2) Slide old pad out of pad holder.
- 3) Insert replacement pad so that notch lines up with keeper pinhole in pad holder.
- 4) Replace Keeper Pin.

WARNING

For your safety properly insert Keeper Pin.

For your safety brake pads have to be mounted respecting "forward" direction.

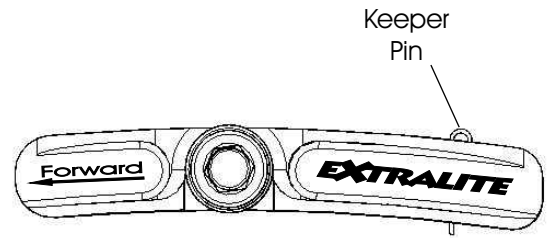

BEARINGS REPLACEMENT:

Brakes arms and bearing spacers are factory matched. Do not mix.

EXTRALITE

Extralite Limited Warranty

Extralite products are warranted against defects in materials and/or workmanship for a period of two years from original date of purchase to the original owner only.

Any Extralite product that is returned and found by Studio Riva to be defective in materials and/or workmanship will be repaired or replaced at the sole discretion of Studio Riva. This warranty is the sole and exclusive remedy.

Studio Riva shall not be held liable for any indirect, special or consequential damages.

The warranty is expressly limited to repair or replacement of the product that has been returned and found to be defective by Studio Riva and are the sole remedy of the warranty.

No credits or refunds will be issued.

The warranty does not cover: normal wear, tear and fatigue; damage or failure due to accident or collision. Improper assembling, poor maintenance, alterations or modifications,

installation of parts not compatible with Extralite products void this warranty.

Warranty does not cover damage arising from crash, abuse and/or misuse or any other circumstances in which the product had been subjected to forces or loads beyond its design.

Immediately replace the component after crash and violent shock, or after continuous heavy use.

Improper use, modification and/or part changing, including surface finishing, could irreparably damage the component.

All labor charges for warranty service are responsibility of the product owner.

INSTALLATION WARNING:

Extralite components are extremely performing and lightweight, crafted with very high quality, they request adequate installation and maintenance care.

We strongly recommended that a professional bike shop install and service your Extralite components.

Improper assembly and/or adjustment may significantly compromise strength and durability of the component causing serious personal injury.

Carefully check proper tightening torque of every bolt.

Always respect installation recommendations.

Extralite components are designed for a specific use X-Country or Road or Downhill, respect product specific destination.

Note: the rider assumes all the risks regarding use and installation of Extralite components.

Garanzia Extralite

I prodotti Extralite sono garantiti contro ogni difetto di costruzione o del materiale, per due anni dalla data di acquisto al solo acquirente originale.

La garanzia offre espressamente la sola sostituzione o riparazione del prodotto riconosciuto difettoso, ad insindacabile giudizio dello Studio Riva. Questa garanzia rappresenta l'unica ed esclusiva forma di rimedio. Il prodotto ritenuto difettoso deve essere smontato e recapitato allo Studio Riva; tutti i costi inerenti il servizio sono a carico del proprietario del prodotto.

L'utilizzatore si assume ogni responsabilità per perdite o danni indiretti, particolari o conseguenti all'utilizzo del prodotto. La garanzia non copre: la normale usura ed affaticamento del prodotto; danni o malfunzionamenti causati da incidenti, modifiche o installazioni di altri componenti non compatibili con il prodotto Extralite.

Non sono coperti da garanzia danni o rotture causate da abuso, da forze o carichi superiori a quelli previsti o da un utilizzo del prodotto diverso da quello per cui è stato progettato.

Invalidano la garanzia: il montaggio o la manutenzione inadeguati, modifiche e/o alterazioni del prodotto.

Uso improprio, manomissione (anche solo della superficie) e/o sostituzione di sue parti possono danneggiare irrimediabilmente il prodotto. Sostituire immediatamente il componente dopo incidenti, shock violenti o un prolungato utilizzo gravoso.

AVVERTENZE PER L'INSTALLAZIONE:

I componenti Extralite sono prodotti di elevatissima resistenza ed estrema leggerezza, sono realizzati con grande cura e precisione e richiedono un'installazione altrettanto meticolosa.

Raccomandiamo di far eseguire l'installazione e la manutenzione dei componenti Extralite da un meccanico professionista.

Un montaggio e una regolazione impropri possono compromettere significativamente la durata e la resistenza del componente causando anche gravi incidenti.

Curate in particolar modo le coppie di serraggio della viteria e le raccomandazioni per l'installazione.

I componenti Extralite sono studiati per un esclusivo impiego X-Country o Strada o Downhill, rispettate la destinazione specifica del prodotto.

NOTA: il proprietario si assume tutti i rischi riguardo l'utilizzo e l'installazione dei componenti Extralite.