

UltraBrakes

Read carefully instruction before installation

FEATURES

Weight: 99gr. (Pair)
Material: Titanium Gr5, AL7075T6, Derlin
Compatibility: direct-pull type levers.
Finishing: "hart coat" / black anodized
Graphics: laser etched
Destination: X-Country use.

UltraBrakes are designed to be used with UltraLevers or direct-pull V-brake specific levers.

INSTALLATION

Brake Arms installation

- 1) Clean and grease brake bosses.
- 2) Insert Linear Spring into Slider.
- 3) Insert Spring Holder and Brake Arm onto brake boss.
- 4) Always insert Brake Pin into central brake boss hole.
- 2) Tighten Mounting Bolt at 4-6Nm (use medium threadlock - Loctite 243).

Pads installation

- 1) Assemble washers exactly as shown in figure. Notice that you can switch position of Thick Spacer (gun metal) and Thin Spacer (black) to get 2 spacing options.
- Brake pads have to be mounted respecting "forward" direction.

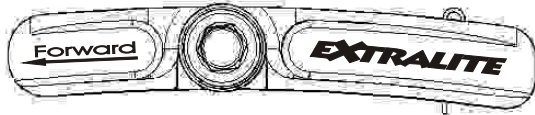

- 2) Check that Brake Arms are parallel when brake pads are on the rim, if not you can switch Spacers.
 - 3) Adjust brake pads: manually press both pads against the rim, than tight the Fixing Nut at 6-8Nm (use anti-seize grease on titanium thread).
- Brake pads have to be parallel to rim and centered on rim braking surface.
WARNING: brake pads should never get in contact with tyre, in any position of brake arms.

Cable installation

- 1) Insert brake cable throught the cable pipe and hook it into the Link.
- 2) Insert cable into boot and position it between Anchor Bolt and Groove.
- 3) Pull the cable tight enough to allow 1-1.5mm rim-to-pad clearance.
- 4) Tighten the cable Anchor Bolt to 4-6Nm with a 5mm hex wrench.
- 5) Check that cable operation is smooth before proceeding.

Spring balancing

- 1) Center the brake pads adjusting left/right spring tension. Turn each Micro Adjuster with a 1.5mm hex wrench (clockwise to increase spring tension).
 - 2) Squeeze brake lever and check that Micro Adjusters tuning always allow an even return of left and right Brake Arm.
- NOTICE: For best performance and feel use low friction cable & housin, tune spring preload at the minimum that allows a proper cable/lever return.
Cable housing type and lenght sensibly influence spring balancing.

TEST THE SYSTEM

Squeeze brake lever several times to make cable properly seated. Check that cable does not slip at the cable anchor bolt/groove. Re-torque if necessary.
Test ride in safe conditions. Check again that the complete system is properly mounted and adjusted. Check again brake pad positioning is still correct, adjust and re-torque if necessary.

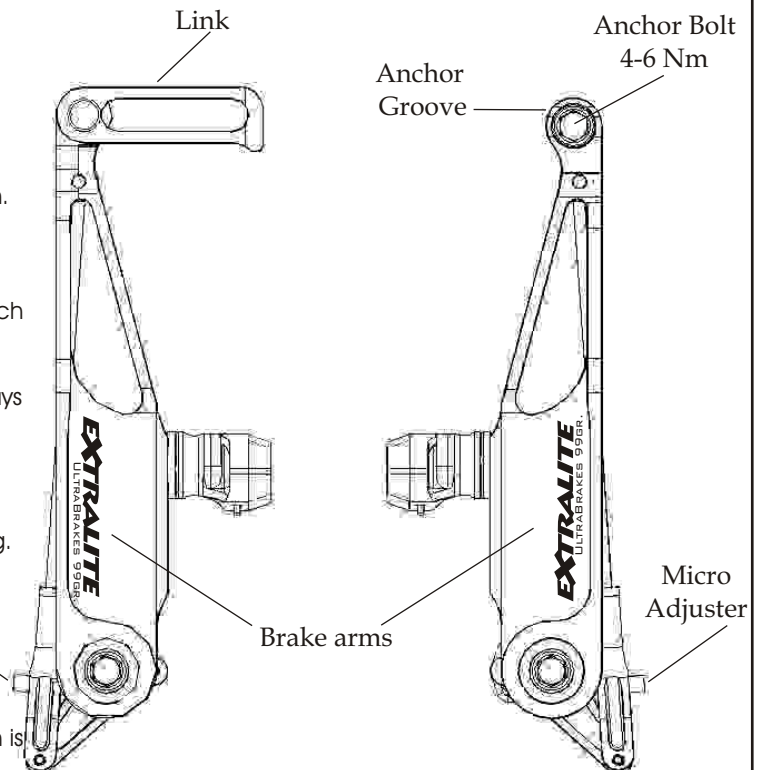
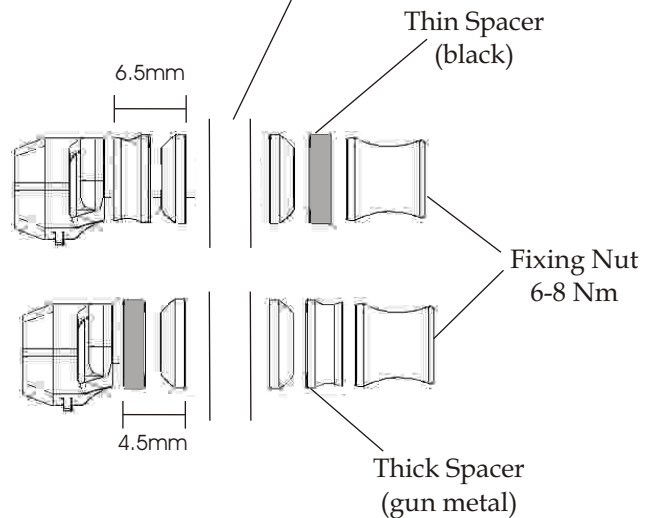
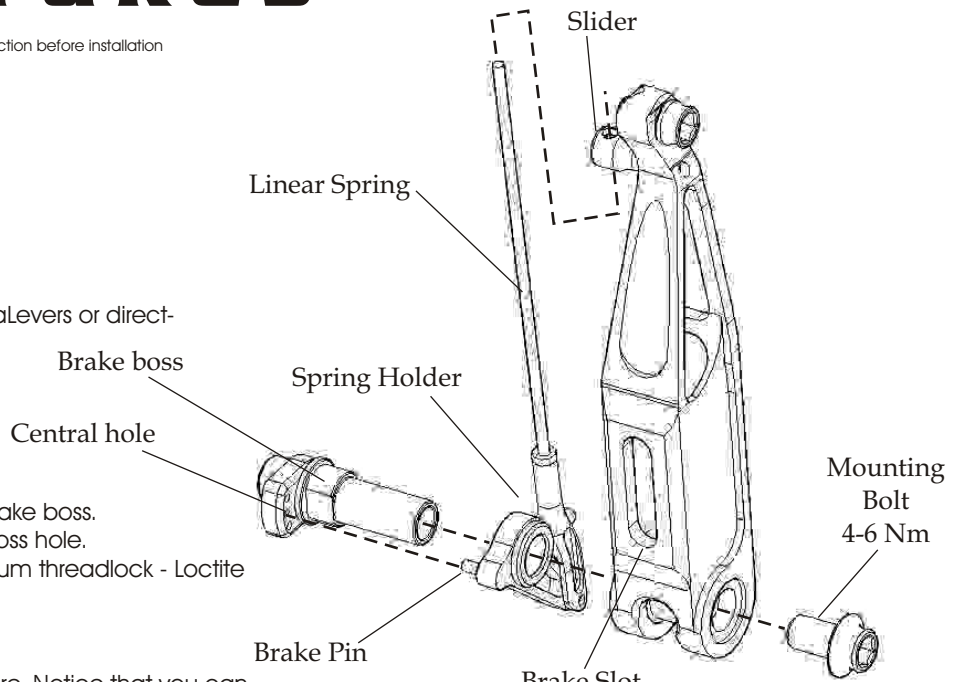

PAD REPLACING INSTRUCTIONS:

- 1) Remove Keeper Pin from pad holder.
- 2) Slide old pad out of pad holder.
- 3) Insert replacement pad so that notch lines up with keeper pinhole in pad holder.
- 4) Replace Keeper Pin.

WARNING

For your safety properly insert Keeper Pin.

For your safety brake pads have to be mounted respecting "forward" direction.

